



ATTENTION
OBSERVE PRECAUTIONS
FOR HANDLING
ELECTROSTATIC
DISCHARGE
SENSITIVE
DEVICES



Features

- Long operating life
- Highest flux
- Available in green
- Lambertian radiation pattern
- More energy efficient than incandescent and most halogen lamps
- Low voltage DC operated
- Cool beam, safe to the touch
- Instant light (less than 100ns)
- Fully dimmable
- No UV
- Superior ESD protection
- RoHS compliant

Applications

- Fiber optic alternative/Decorative/entertainment
- Mini-acet/Up lighters/Down lighters/Orientation
- Indoor/Outdoor commercial and Residential Architectural
- Cove/Under shelf/Task
- Bollards/Security/Garden
- Portable(flashlight,bicycle)
- Edge-lit signs(Exit,point of sale)
- Automotive Exit (Stop-Tail-Turn,Chmsl,Mirror Side Repeat)
- Traffic signaling/Beacons/Rail Crossing and Wayside

Radiation Pattern

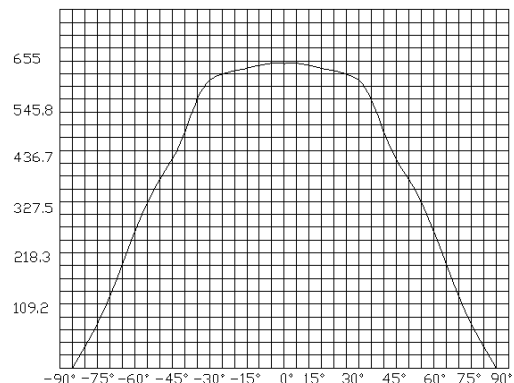
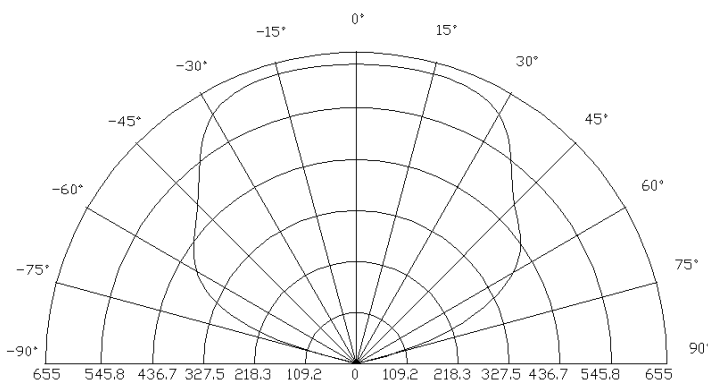

Typical Optical/ Electrical Characteristics @T_a=25°C

| Item | Symbol | Condition | Min. | Typ. | Max. | Unit |
|-------------------------------------|-------------------|-----------------------|------|------|------|------|
| Forward Voltage | V _F | I _F =700mA | 3.0 | -- | 4.0 | V |
| Reverse Current | I _R | V _R =5v | -- | -- | 30 | uA |
| 50% Power Angle | 2θ _{1/2} | I _F =700mA | 120 | -- | 140 | deg |
| Luminous Flux | φ _v | I _F =700mA | 120 | 140 | | lm |
| Recommend Forward Current | I _F | -- | | 700 | | mA |
| Wave Length | λ _d | I _F =700mA | 520 | | 530 | nm |
| Thermal Resistance,Junction to Case | R _{JP} | I _F =700mA | -- | 10 | -- | °C/w |

The sample delivers goods data

| Item | Symbol | Condition | Min. | Avg. | Max. | Unit |
|-----------------|-------------------|-----------------------|------|------|------|------|
| Luminous Flux | φ _v | I _F =700mA | | | | lm |
| 50% Power Angle | 2θ _{1/2} | | | | | deg |
| Forward Voltage | V _F | | | | | v |
| Wave Length | λ _d | | | | | nm |

Notes:

- 1.Tolerance of measurement of forward voltage±0.1V.
- 2.Tolerance of measurement of peak Wavelength±2.0nm.
- 3.Tolerance of measurement of luminous Flux±15%.

Absolute Maximum Rating

| Item | Symbol | Absolute Maximum Rating | Unit |
|-----------------------------|------------------|--------------------------|------|
| Forward Current | I _F | 700 | mA |
| Peak Forward Current* | I _{FP} | 1000 | mA |
| Reverse Voltage | V _R | 5 | V |
| Power Dissipation | P _D | 3000 | mW |
| Electrostatic discharge | E _{SD} | ±2000 | V |
| Operation Temperature | T _{OPR} | -40~+80 | °C |
| Storage Temperature | T _{STG} | -40~+100 | °C |
| Lead Soldering Temperature* | T _{SOL} | Max. 260°C for 3sec Max. | |

*IFP Conditions: Pulse Width≤10msec duty≤1/10

* All high power emitter LED products mounted on aluminum metal-core printed circuit board, can be lighted directly, but we do not recommend lighting the high power products for more than 5 seconds without a appropriate heat dissipation equipment.

* Re-flow,wave peak and soak-stannum soldering etc.is not suitable for this products.

* Suggest to solder it by professional high power LED soldering machine.

* Can use invariable-temperature searing-iron with soldering condition:≤260 degree less than 3 seconds.



| | |
|-------------------|---|
| Under Development | |
| Mass production | ● |

Typical Optical/Electrical Characteristics Curves
($T_a=25^{\circ}\text{C}$ Unless Otherwise Noted)

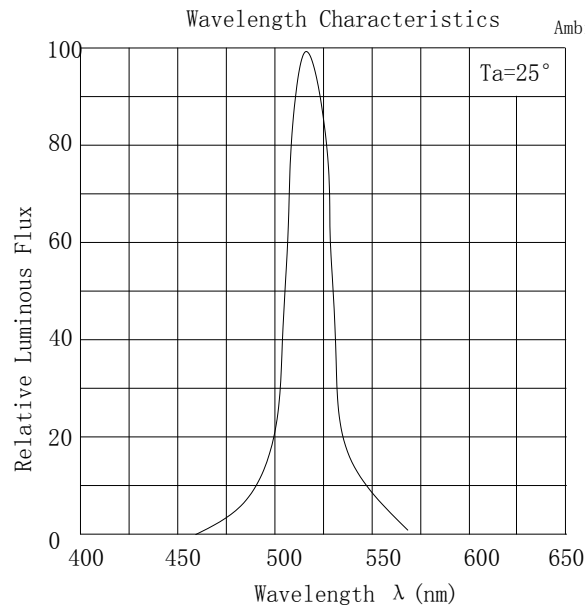
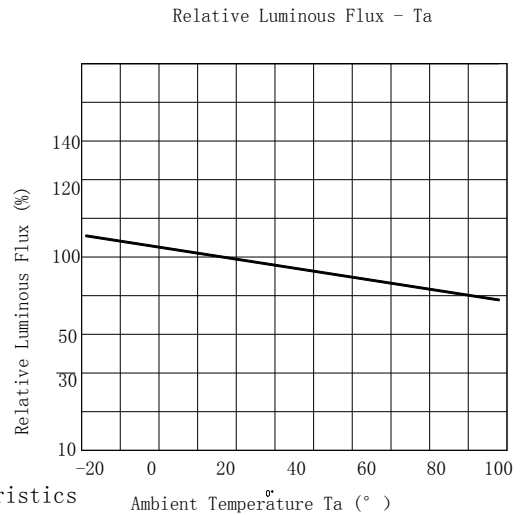
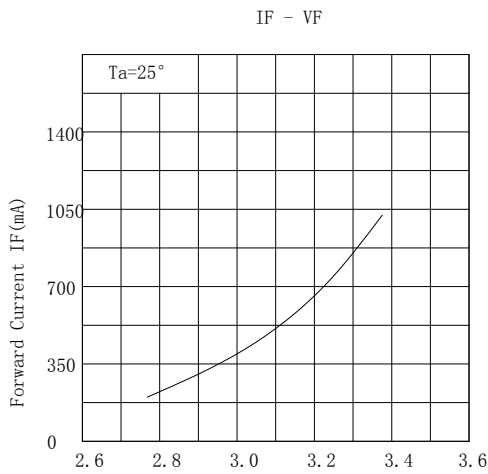
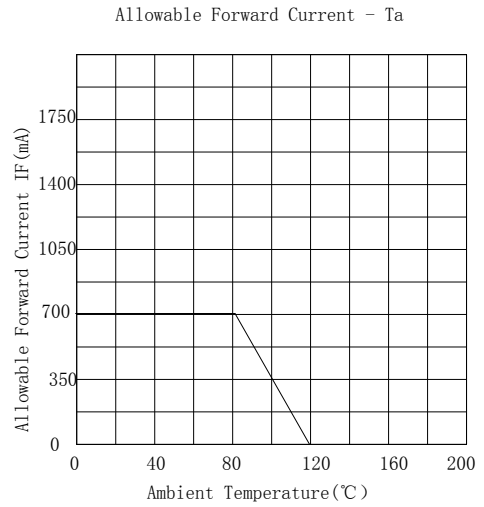
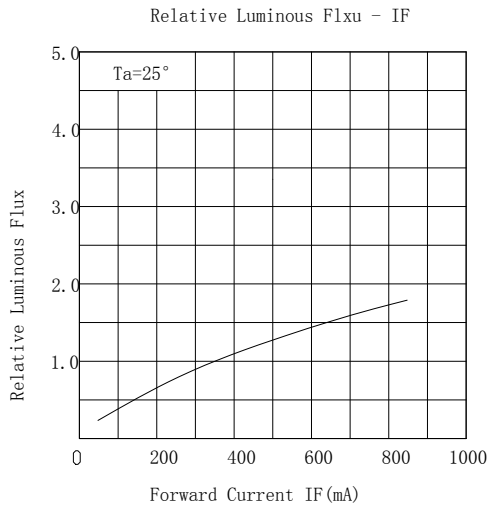

Package Dimensions

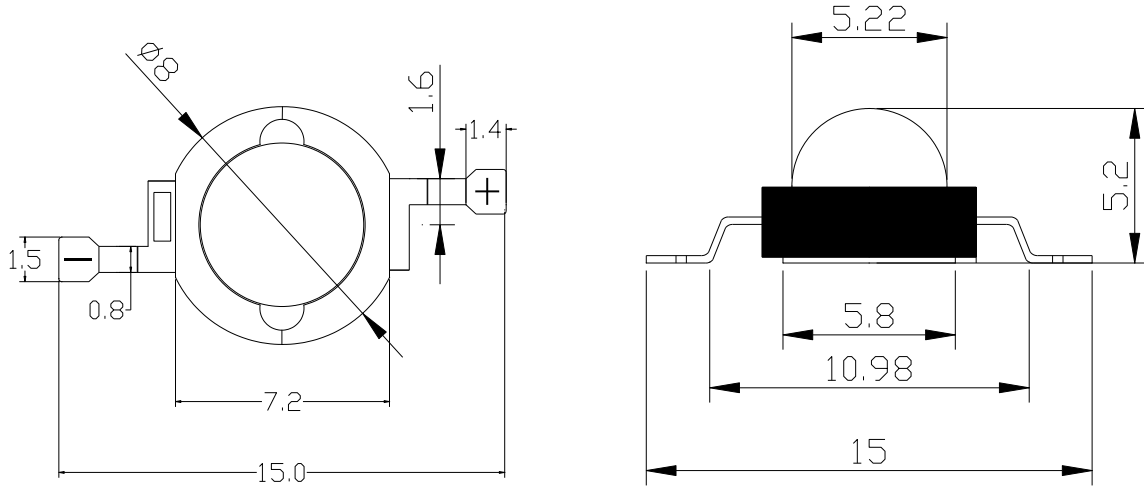

Notes:

1. All dimension units are millimeters.
2. All dimension tolerance is $\pm 0.2\text{mm}$ unless otherwise noted.

Tape Specifications(Units:mm)

