



ATTENTION
OBSERVE PRECAUTIONS
FOR HANDLING
ELECTROSTATIC
DISCHARGE
SENSITIVE
DEVICES



Features 特点

- Long operating life 寿命长
- Highest flux 光通量高
- Available in Blue 蓝光
- Lambertian radiation pattern 朗伯光照模式
- More energy efficient than incandescent and most halogen lamps (发光效率高)
- Low voltage DC operated (低电压直流工作)
- Cool beam, safe to the touch
冷光源, 接触安全
- Instant light (less than 100ns)
瞬间点亮 (小于100ns)
- Fully dimmable(属于可调光)
- No UV (无紫外线)
- Superior ESD protection(较好的防静电保护)
- RoHS compliant (符合RoHS标准)

Applications 应用

- Reading lamps 阅读灯
- Portable lightings /(flash lightings, bicycle) 便携式照明
- Indoor/Outdoor lightings 户内外照明
- Edge-lit signs (Exit, point of sale)
- Traffic signaling 交通照明
- Architectural, landscaping and entertainment/advertising installations.
建筑, 园林绿化和娱乐/广告装置照明.

Radiation Pattern 辐射模式

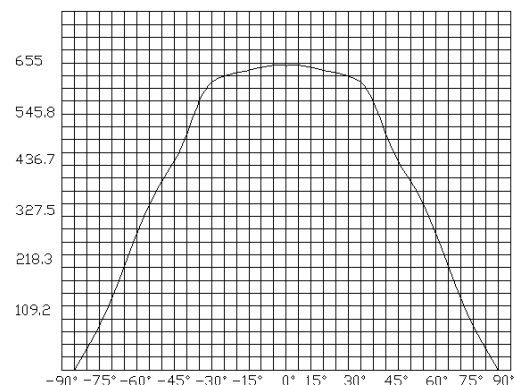
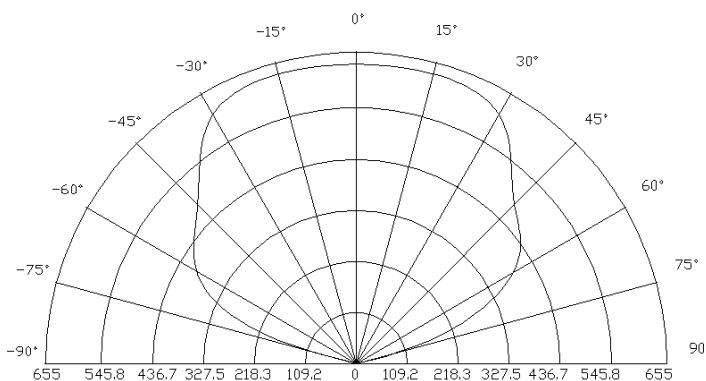

Typical Optical/ Electrical Characteristics @T_a=25°C 典型的光学/电气特性在 Ta=25° C

Item名称	Symbol 符号	Condition 条件	Min. 最低	Typ. 典型	Max. 最高	Unit 单位
Forward Voltage正向电压	V _F	I _F =700mA	3.0	--	4.0	V
Reverse Current反向电流	I _R	V _R =5v	--	--	30	uA
50% Power Angle发光角度	2θ1/2	I _F =700mA	120	--	140	deg
Luminous Flux光通量	Φ _v	I _F =700mA	39.8	45.3		lm
Recommend Forward Current 正向电流	I _F	--		—	700	mA
Chromaticity (色温)	λ _d	I _F =700mA	460	--	470	nm
Thermal Resistance, Junction to Case 热阻	R _{JP}	I _F =700mA	--	10	--	°C/w

The sample delivers goods data 送货样品资料

Item名称	Symbol 符号	Condition 条件	Min. 最低	Typ. 典型	Max. 最高	Unit 单位
Luminous Flux光通量	Φ _v	I _F =700mA				lm
50% Power Angle发光角度	2θ1/2					deg
Forward Voltage正向电压	V _F					v
Wave Length波长	λ _d					nm

Notes注:

1. Tolerance of measurement of forward voltage±0.1V、peak Wavelength±2.0nm、luminous flux±15%
 测量正向电压误差为±0.1、误差为2.0nm、光通量误差为±15%。

Absolute Maximum Rating 绝对最大额定值在Ta = 25° C

Item名称	Symbol 符号	Absolute Maximum Rating 绝对最大额定值	Unit单位
Forward Current正向电流	I _F	700	mA
Peak Forward Current*峰值正向电流	I _{FP}	1000	mA
Reverse Voltage反向电压	V _R	5	V
Power Dissipation耗散功率	P _D	3000	mW
Electrostatic discharge抗静电能力	E _{SD}	±2000	V
Operation Temperature工作温度范围	T _{OPR}	-40~+80	°C
Storage Temperature储存温度范围	T _{STG}	-40~+100	°C
Lead Soldering Temperature*引线焊接温度	T _{SOL}	Max. 260°C for 3sec Max.	

*IFP Conditions: Pulse Width≤10msec duty≤1/10 IFP的条件: 脉冲宽度≤10毫秒 占空比≤1/10

* All high power emitter LED products mounted on aluminum metal-core printed circuit board, can be lighted directly, but we do not recommend lighting the high power products for more than 5 seconds without a appropriate heat dissipation equipment. 所有高功率的发光LED产品安装在铝金属为核心印刷电路板, 可直接点亮, 但我们不建议在没有一个适当的散热设备时, 照明高功率LED点亮超过5秒

wave peak and soak-stannum soldering etc.is not suitable for this products.波峰焊、浸锡焊接不适合这个产品

Reflow soldering should not be done more than two times. The reflow temperature we recommend is 180°C

回流焊不能超过两次, 回流焊最高温度建议180°C。



High Power Emitter LED P/N:EK4B3NAVS(Blue)

Under Development	
Mass production	●

Typical Optical/Electrical Characteristics Curves 典型光学/电性特征曲线 ($T_a=25^{\circ}\text{C}$ Unless Otherwise Noted) ($T_a=25^{\circ}\text{C}$ 除非另有注释)

Relative Luminous Flux - IF
正向电流与相对光强曲线图

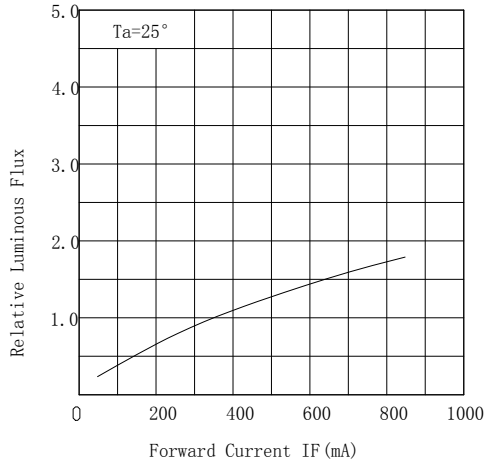

Allowable Forward Current - Ta
环境温度与正向电流曲线图

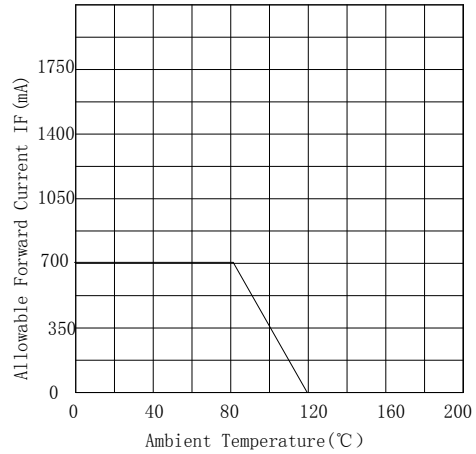

IF - VF
正向电流与正向电压曲线图

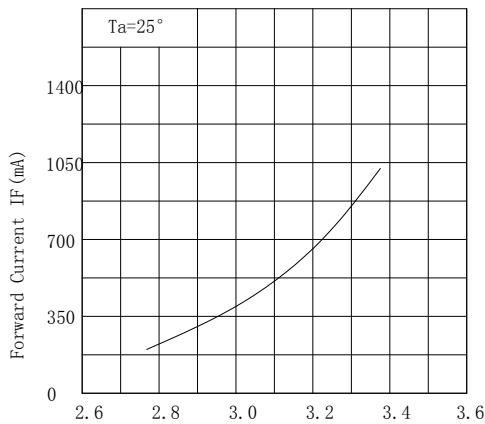

Relative Luminous Flux - Ta
环境温度与相对光强曲线图

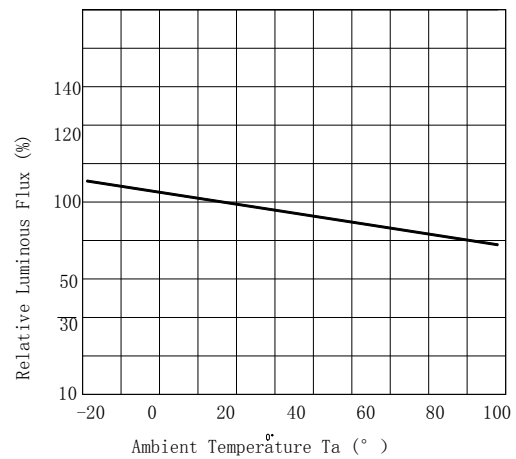

Wavelength Characteristics
相对光谱分布曲线图

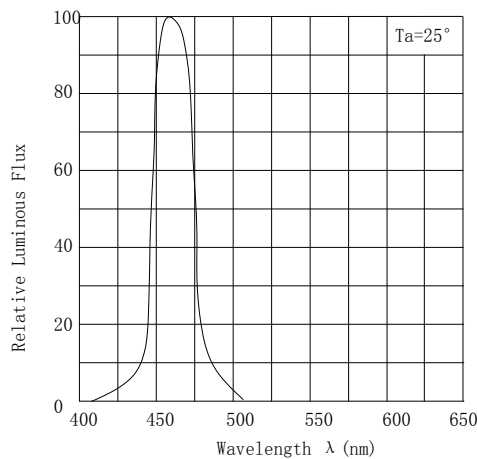

Package Dimensions 封装尺寸

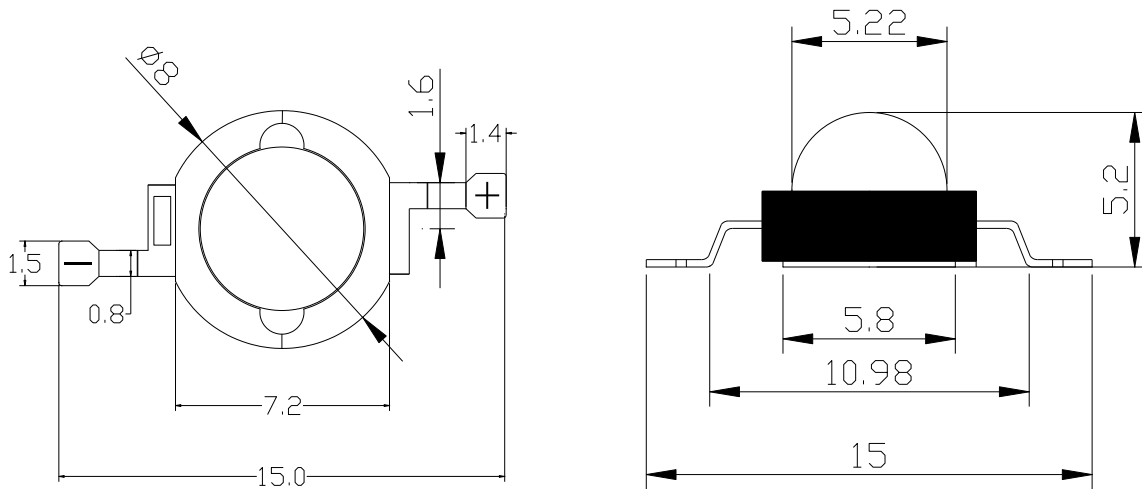

Notes 注意:

1. All dimension units are millimeters. 所有尺寸单位均为毫米。
2. All dimension tolerance is $\pm 0.2\text{mm}$ unless otherwise noted. 所有尺寸误差是 ± 0.2 毫米除非另有说明

Tape Specifications (Units: mm) 载带规格 (单位: mm)

