

SURFACE-MOUNT POWER INDUCTORS

SMD4D06-4D08 SERIES

FEATURES:

- Low DC Resistance
- Large current up to 0.95A
- Excellent Mechanical Strength
- High Reliability and Excellent Solderability
- Low and square Profile
- High heat resistance

OPTIONS:

- Packaging:Tape & Reel is standard (Qty:2000pcs)
Bulk packaging available for smaller quantities
- Tolerance:10% and 5% is standard, tighter tolerances available

COMMON APPLICATIONS:

- VCRs, Notebook, DC/DC Converters
- Video Digital Cameras
- Communication System
- Automotive Systems Power supplier
- LCD PDP Televisions
- Hard Disk Drives, Topset, XDSL
- Network Systems
- Computer Peripheral Equipment

ELECTRICAL CHARACTERISTICS:

Part Number	L μ H	Test Freq KHz	DCR Ω Max	IDC Max A	Part Number	L μ H	Test Freq KHz	DCR Ω Max	IDC Max A
SMD4D06-2R2M	2.2	100	0.116	0.95	SMD4D08-3R3M	3.3	100	0.060	0.85
SMD4D06-3R3M	3.3	100	0.174	0.77	SMD4D08-4R7M	4.7	100	0.194	0.80
SMD4D06-4R7M	4.7	100	0.216	0.75	SMD4D08-6R8M	6.8	100	0.276	0.65
SMD4D06-6R8M	6.8	100	0.296	0.62	SMD4D08-100M	10	100	0.335	0.57
SMD4D06-100M	10	100	0.457	0.50	SMD4D08-150M	15	100	0.508	0.45
SMD4D06-150M	15	100	0.676	0.40	SMD4D08-220M	22	100	0.766	0.37
SMD4D06-220M	22	100	1.066	0.30	SMD4D08-330M	33	100	1.162	0.28
SMD4D06-330M	33	100	1.647	0.24	SMD4D08-470M	47	100	1.658	0.22
SMD4D06-470M	47	100	2.843	0.18	SMD4D08-680M	68	100	2.534	0.18

Note:1. K= ± 10%,M= ± 20%,N= ± 30%

TECHNICAL INFORMATION & PHYSICAL CHARACTERISTICS

- Inductance Testing: HP4284A, HP4285A or equivalent
- RDC:QuadTech 1880 Milliohmeter
- Q- HP4342A
- SRF-HP4191A or HP4194A
- Rated Current L value drop10%typ.at I_{DC} against its initial value
- Temperature rise 40°CMax
Reference ambient temperature
- Solderability: 75% of the lead wire
Shall be covered
- Soldering Methods: Wave,Reflow
- Operating Temperature:-25°C to +85°C
- Storage Temperature: -55°C to +125°C
- Terminal bending strength:24.5N Min
- Moisture resistance:
 $\Delta L/L \leq \pm 10\%$ $\Delta Q/Q \leq \pm 25\%$

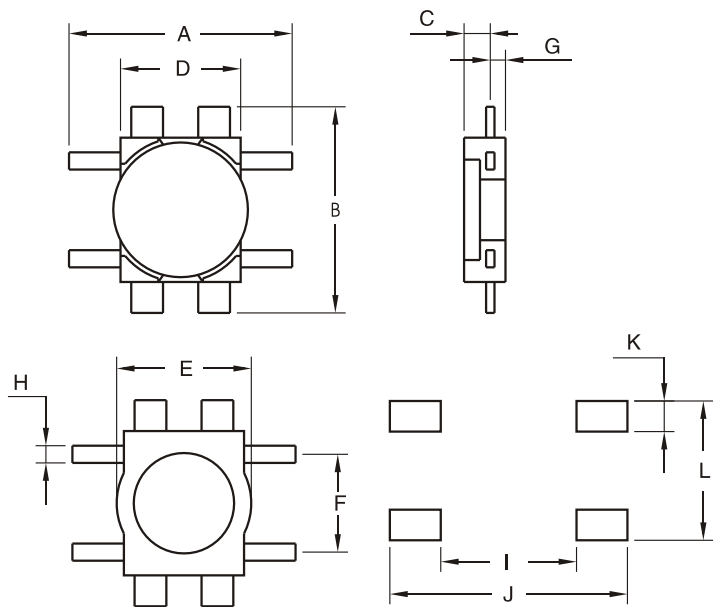

LAND PATTERNS

DIMENSIONS IN:mm

Part number	A	B	C	D	E	F	G	H	I	J	K	L
SMD4D06	6.5Max	6.0Max	0.8Max	3.5	4.1	3.2	0.4	0.5	4	7	0.9	4.1
SMD4D08	6.2Max	5.8Max	1.0Max	3.5	4.1	3.2	0.4	0.5	4	7	0.9	4.1

Note:All specifications subject to change without notice.