

REV.	DESCRIPTION	DATE	DRAWN	APPROVED
A1	DWG.REL	2016/10/7	FANG	YANG

- Material
 - ØScrews : M3.0 steel, Ni plated
 - ØHousing : PA66,UL94V-0
 - ØTerminal : Brass, Tin plated

- Electrical
 - UL IEC
 - Rated voltage : 300V 250V
 - Rated current : 15A 24A
 - Insulation resistance: 500MΩ/DC500V
 - Withstanding Voltage : AC2000V/1min
 - Wire range: 22-14AWG 2.5mm²

- Mechanical
 - Operating temperature: -40°C ~ +105°C
 - Soldering temperature: 250°C ± 5 / 5sec
 - Torque: 0.5N.m (4.43lb.in)

HOW TO ORDER

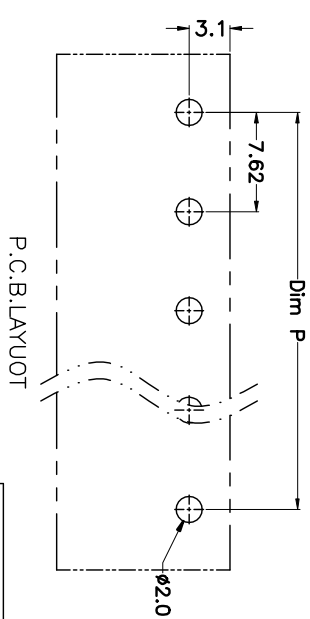
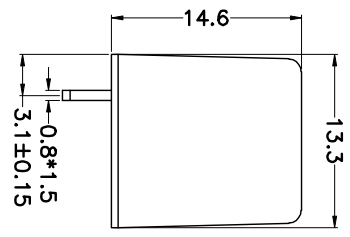
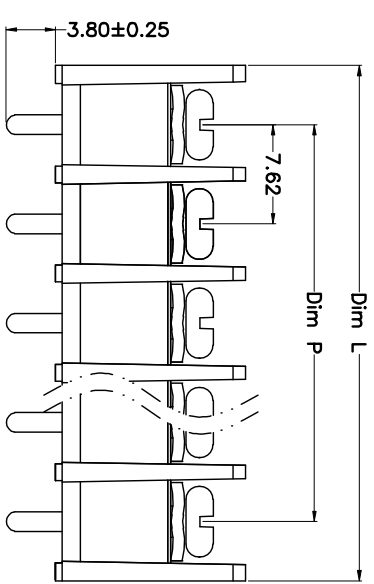
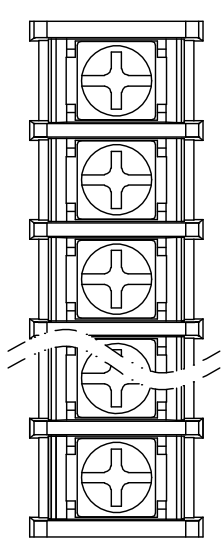
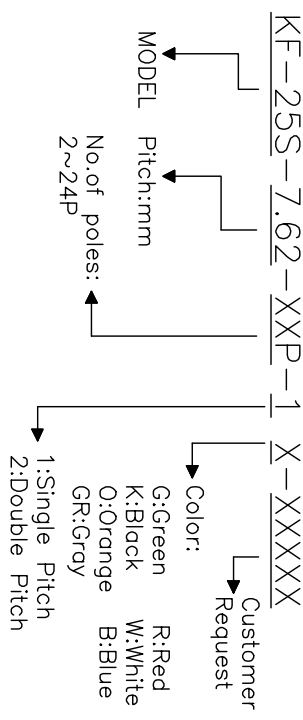

N=Number of Poles
 Dim P=(N-1)×7.62
 Dim L=N×7.62±1.5

Poles	Dim P	Dim L
2-6P	±0.10	±0.15
7-12P	±0.20	±0.20
13-18P	±0.25	±0.30
19-24P	±0.30	±0.40

GENERAL TOLERANCE

UNITS	ANGLE TOLERANCE
X, ±0.5	X, ±5'
X, ±0.3	X, ±3'
.XX, ±0.1	.XX, ±1'

DRAWING TYPE CUSTOMER SCALE 1:1 SHEET 1 OF 1

DRAWING NO. XP0012016-xxxx

PROJECTION

UNITS	TITLE
mm	KF-25S-7.62-XXP

SHEET SIZE A4 SERIES KF-25S

KALFENG ELECTRONIC **凯峰电子有限公司** CIXI KAIFENG ELECTRONIC CO.,LTD